

## SALTO MORTISE LOCK LE7S

Access control requires a good, reliable door locking system. SALTO offers a wide range of mortise locks in order to ensure that the door is correctly locked.



**SALTO**  
inspired access

### MAIN CHARACTERISTICS:

- Lock case, latch and deadbolt made of steel\*.
- Optional with built-in door detector\*.
- Requires no extra drilling.
- DIN compatible mortise lock case, according to DIN 18251.
- Suitable for XS4 Euro standard escutcheons and electronic cylinders.
- High resistance by use of high quality materials.
- Equipped with antifriction latch for a smoother closing of the door.
- Includes auxiliary latch (anticard system) to prevent unwanted intrusions.
- Axe distance: 72mm.
- Turning angle: 23°.
- Compatible with Euro profile mechanical cylinders.
- Different backsets: 55mm, 60mm, 65mm and 70mm.
- Front plates available: 20mm and 24mm (round or squared).
- Different squared spindles: 8mm or 9mm.
- Optional asymmetric front plate for rebated doors.
- Reversible mortise lock, handing can be set up on site for an easier installation (symmetrical models).
- Includes standard strike plate and dust box for an optimal installation (symmetrical models).
- Highest certifications compliant (60 minute fire test) EN1634-1.

### Operations and functions

- Intelligent integrated door detector to monitor the status of the door without any additional hardware or fitting.\*
- Detection of intrusion alarms.\*
- Opened and closed status of doors through SALTO Wireless technology.\*
- Optional integrated electronic privacy detector for door/room status real-time monitoring.\*
- Anti-panic safety function: In locked position, turning the inside handle retracts auxiliary latch and deadbolt simultaneously.
- The handle retracts the latch and the deadbolt to normal position.
- 1 turn thumbturn full projection.

### Certifications

- Security requirements:
  - Mortise lock EN 12209 Grade 3 (High frequency of use or with care, use in public buildings).\*
- Mechanical certifications against vandalism & fire:
  - EN1634-1 EI 30\*\*
  - EN1634-1 EI 60

\* Depending on the model.

\*\* In process.

## MODEL LE7S05

The SALTOXS4 LE7S05 is a DIN compatible mortise lock that offers a wide range of operations and functions possibilities to improve access control with a reliable locking solution. This mortise lock is specially designed to be compatible with mortise lock case, according to DIN 18251 in order to work in combination with an electronic locking system based on escutcheon. This is a reliable, robust and cost effective mortise lock that suits the basic needs of a locking system.

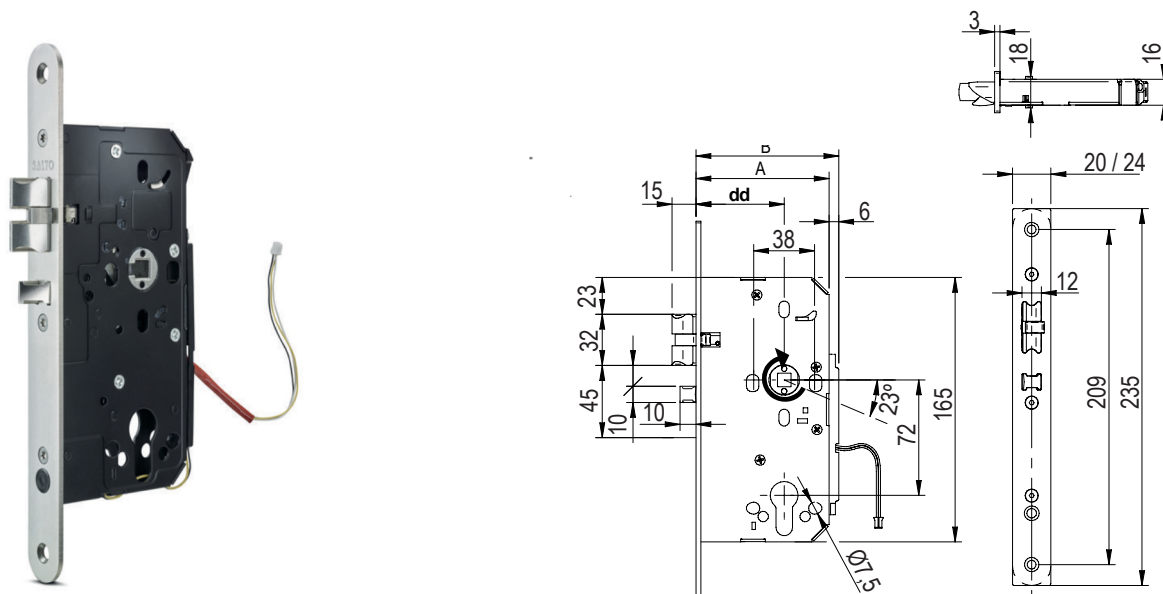

### SALTO Application recommended

- XS4 One Escutcheons
- Ex750, Ex756

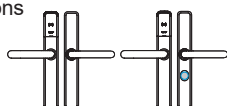

- XS4 Original Escutcheons
- Ex450, Ex456
- Ex550, Ex556
- Ex650, Ex656

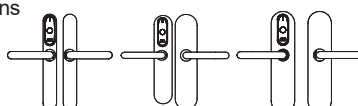

- XS4 Mini Escutcheons
- Ex150



## MODEL LE7S15

The SALTOXS4 LE7S15 is a DIN compatible antipanic mortise lock equipped with latch and deadbolt. This mortise lock is specially designed to be compatible with mortise lock case, according to DIN 18251 in order to work in combination with an electronic locking system based on escutcheon. Equipped with built-in door and privacy detectors it offers a wide range of operations and functions possibilities to improve access control with a reliable locking solution.

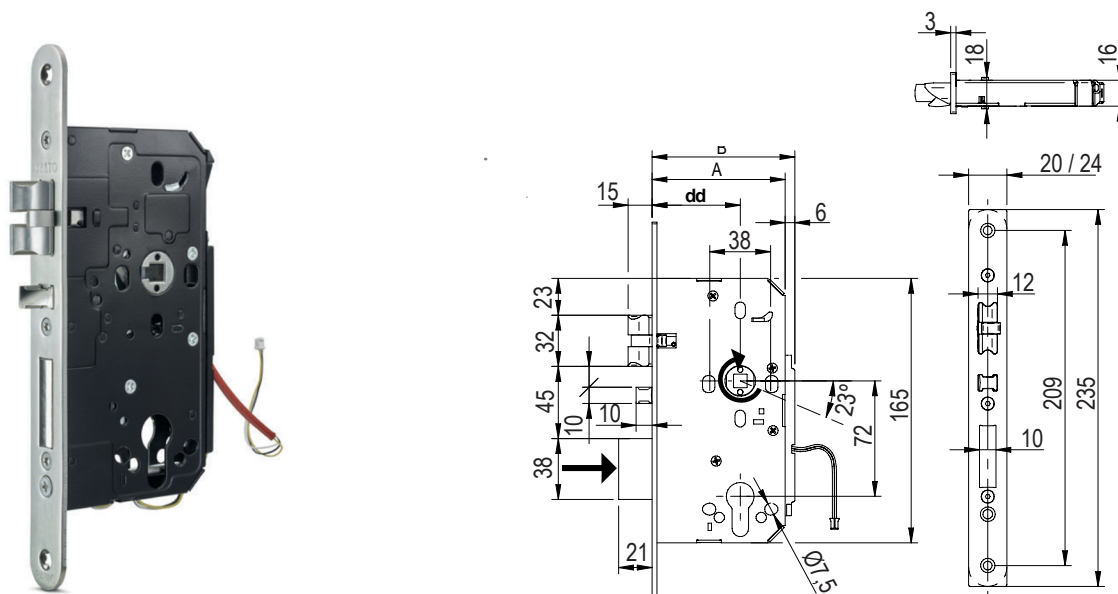

### SALTO Application recommended

- XS4 One Escutcheons
- Ex751 Ex752
- Ex753 Ex754
- Ex757



- XS4 Original Escutcheons
- Ex451, Ex452
- Ex453, Ex454
- Ex457, Ex654
- Ex657

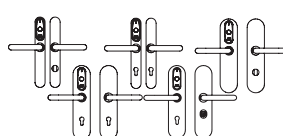

- XS4 Mini Escutcheons
- Ex150
- \*with mechanical cylinder

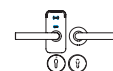

MODEL LE7S25

The SALTO XS4 LE7S25 is a DIN compatible mortise lock equipped with latch and deadbolt. This mortise lock is specially designed to be compatible with mortise lock case, according to DIN 18251 in order to work in combination with an electronic locking system based on electronic cylinders.

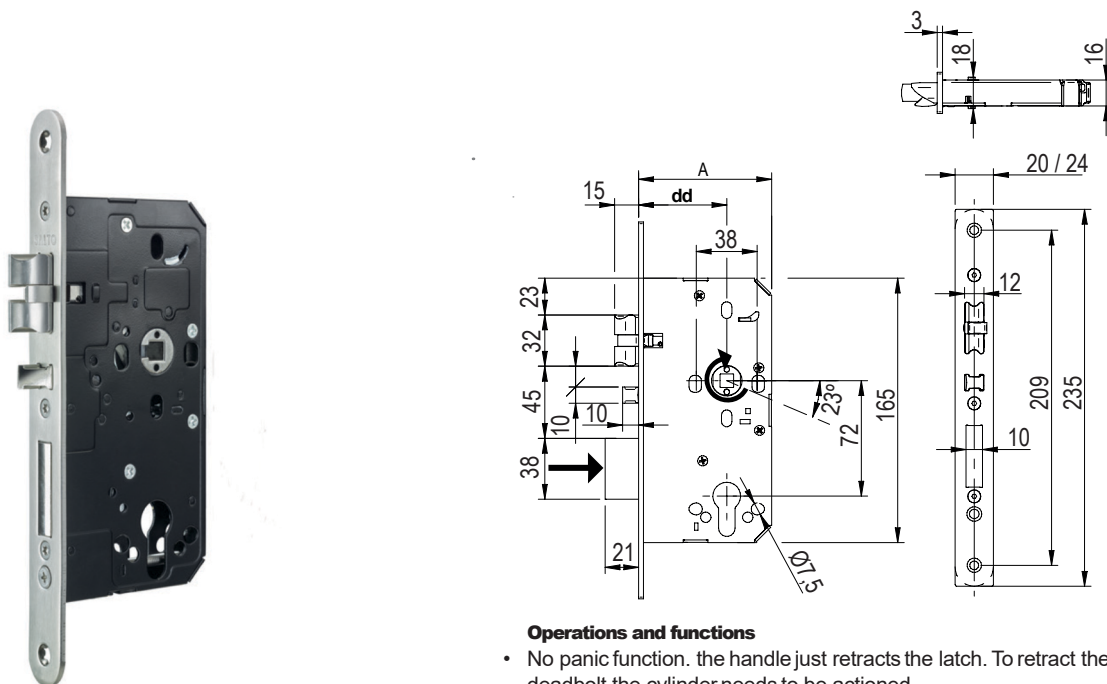

## Operations and functions

- No panic function. the handle just retracts the latch. To retract the deadbolt the cylinder needs to be actioned.



Due to the mechanical and operational characteristics of this mortise lock it causes some exit limitation and should be installed understanding these limitations..

**SALTO Application recommended**

- XS4 One Escutcheons
  - Ex751, Ex752, Ex753,
  - Ex754, Ex757

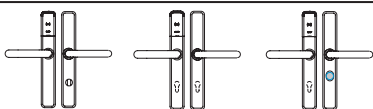

- XS4 Original Escutcheons
  - Ex451 Ex452 Ex453,
  - Ex454 Ex457
  - Ex654 Ex657 escutcheons

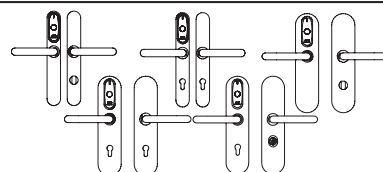

- XS4Mini
  - Ex150 escutcheons
  - \*with mechanical cylinder



- XS4 GEO
  - GxE1, GxE2, GxE3 cylinders

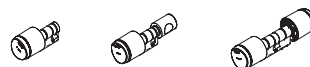

## Handing

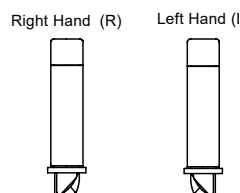
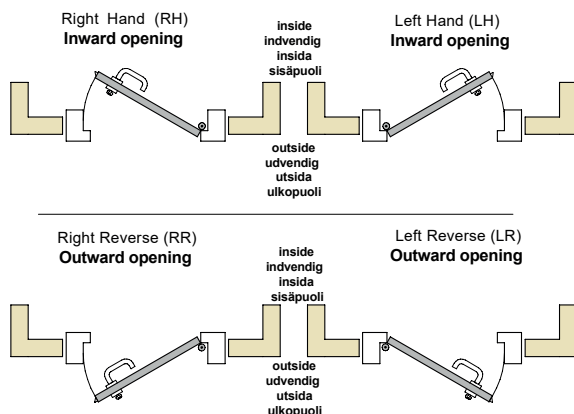

Door code	Lock code
LH	L
RR	
RH	R
LR	